

TYPICAL PILE PLAN VIEW

NOTES :

1. CONCRETE STRENGTH SHALL BE 6,000 PSI MINIMUM AT 28 DAYS AND 3,500 PSI MINIMUM AT TIME OF TRANSFER OF THE PRESTRESSING FORCE.
2. PRESTRESSING STEEL SHALL BE $\frac{1}{2}$ " \emptyset SEVEN-WIRE STRAND, GRADE 270 LOW RELAXATION.
3. SPIRAL TIES SHALL BE 0.22 INCH \emptyset (No. 4 GAGE) MINIMUM. EACH WRAP OF SPIRALS SHALL BE TIED TO AT LEAST TWO CORNER STRANDS. ONE TURN REQUIRED FOR SPIRAL SPLICES.
4. SURFACE FINISH TO BE STEEL TROWEL FINISH.

MAXIMUM PILE LENGTH (FEET)	SQUARE PILE SIZE (INCHES)						REQUIRED STORAGE AND TRANSPORTATION DETAIL	PICK-UP DETAIL
	12	14	18	20	24	30		
48	52	59	62	68	87	2, 3, OR 4 POINT	1 POINT	
69	75	85	89	98	124	2, 3, OR 4 POINT	2 POINT	
99	107	121	128	140	178	3 OR 4 POINT	3 POINT	

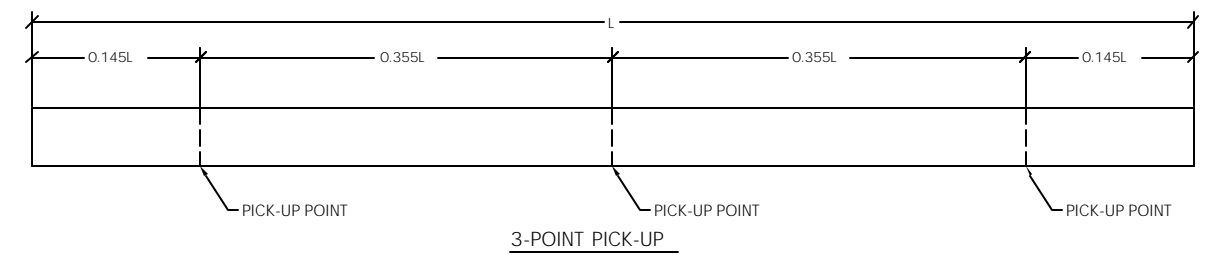
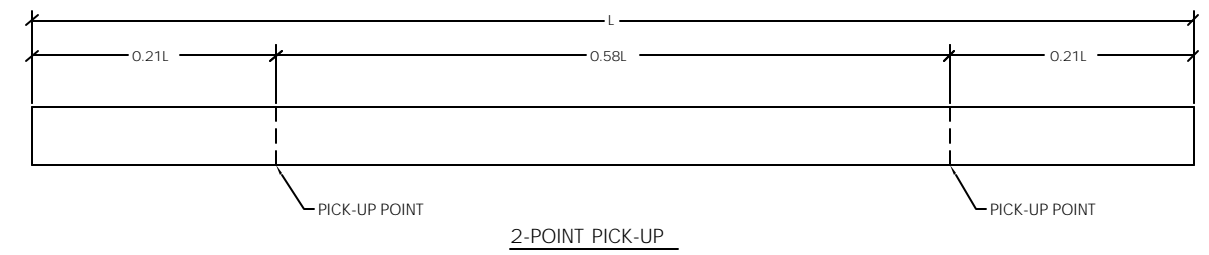
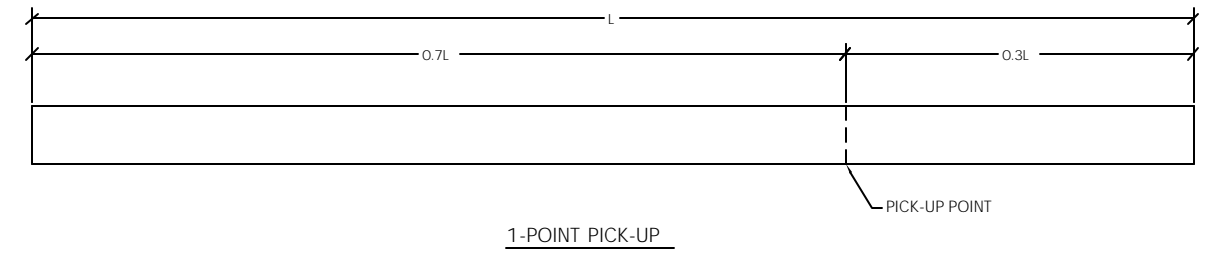

PILE PICK-UP DETAILS
N.T.S

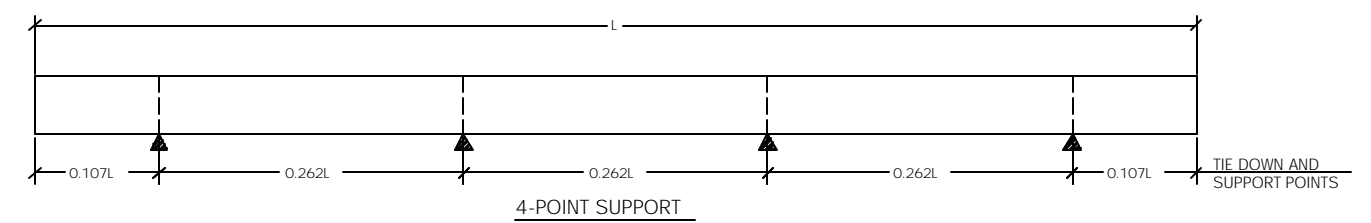
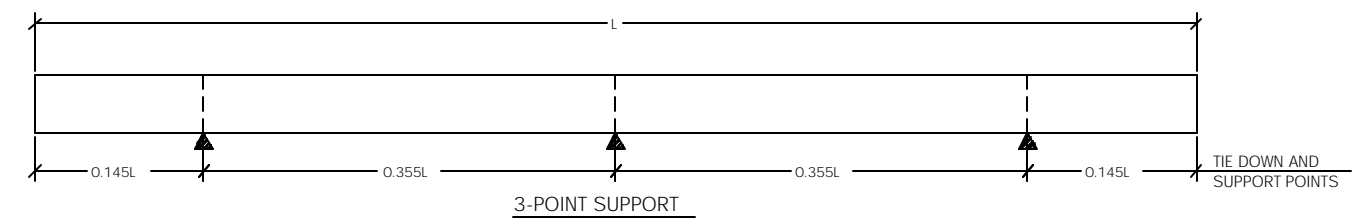
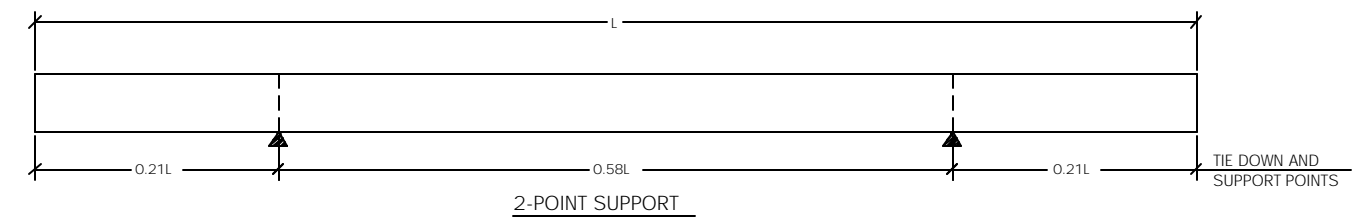

PILE STORAGE AND TRANSPORT SUPPORT DETAILS
N.T.S